

Development of intelligent systems (RInS)

Introductory information

Danijel Skočaj

University of Ljubljana

Faculty of Computer and Information Science

Academic year: 2022/23

About the course

- Development of Intelligent Systems
- University study program Computer and Information Science, 3rd year
- 3 hours of lectures and 2 hours of tutorials (practice classes) weekly
- 6 ECTS credits
- Lectures on Thursdays 8:15 – 11:00 (in P22)
- Tutorials, 5 groups, in R2.38:
 - Tuesdays 8:15 - 10:00 and 12:15-14:00
 - Wednesdays 15:15 – 17:00
 - Thursdays 15:15 – 17:00
 - Fridays 12:15 – 14:00
- Course home page:
<https://ucilnica.fri.uni-lj.si/course/view.php?id=69>

About the course

- Module Artificial intelligence



Lecturer

- Prof. dr. Danijel Skočaj
 - Visual Cognitive Systems Laboratory
 - e-mail: danijel.skocaj@fri.uni-lj.si
 - url: <http://www.vicos.si/danijels>
 - tel: 01 479 8225
 - room: second floor, room R2.57
 - office hours: Thursday, 13:00-14:00
- Teaching assistants:
 - Matej Dobrevski
 - e-mail: matej.dobrevski@fri.uni-lj.si
 - tel: 01 479 8245
 - room: second floor, room R2.37
 - Assist. prof. Luka Čehovin Zajc
 - e-mail: luka.cehovin@fri.uni-lj.si
 - tel: 01 479 8252
 - room: second floor, room R2.35



ViCOS
visual cognitive
systems lab



Goal of the course

The course aims at teaching the students to develop an intelligent system by integrating techniques from artificial intelligence and machine perception. Students will learn how to design an intelligent system, how to select which tools and methods to use, and how to implement new components and integrate them into a functional system.

Course goals

- To learn about intelligent robot systems
 - requirements
 - methodologies
 - applications
 - middleware
- Development of an intelligent robot system
 - design
 - architecture
 - use of appropriate components
 - development of new components
 - integration
 - robot programming
 - testing, debugging
- Extremely practically oriented course!

Development platform

- Robot platform: iRobot Roomba 531 + TurtleBot + Kinect
- Software platform: ROS, Robot Operating System



ROS



TurtleBot++

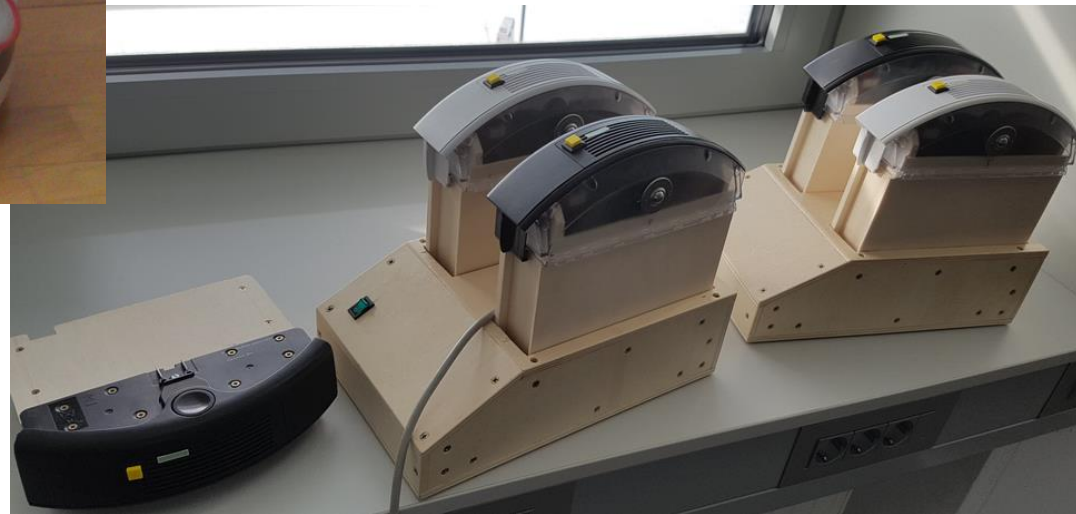
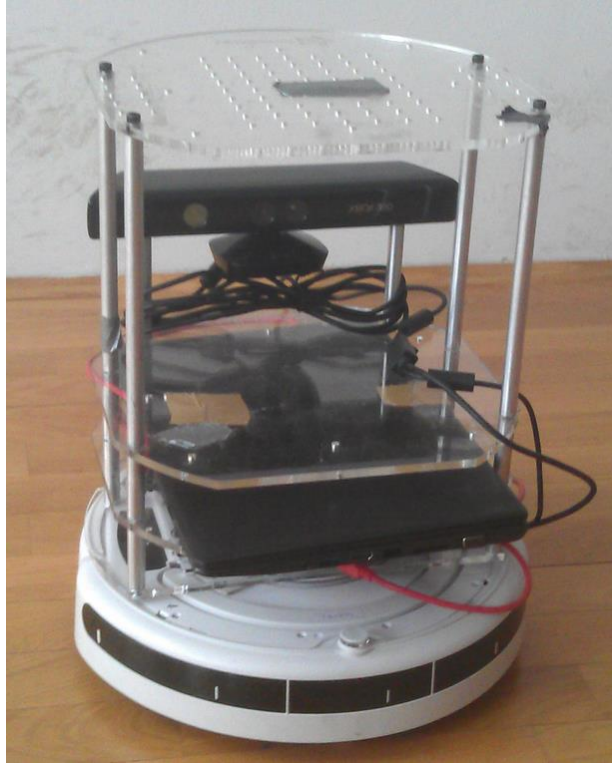

Herd



Robot platform



Diploma theses



G. Pušnik



A. Rezelj



D. Tratnik

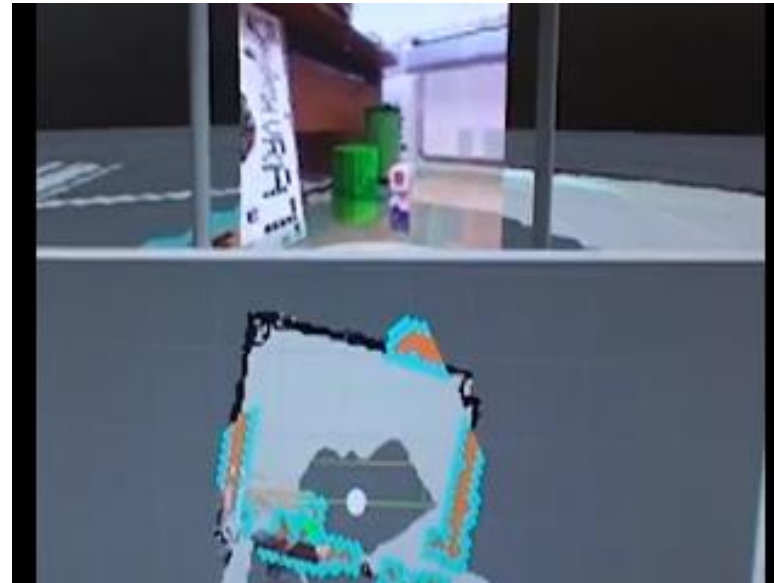

J. Bizjak

- Slalom



- Object search



- Mini Cluedo

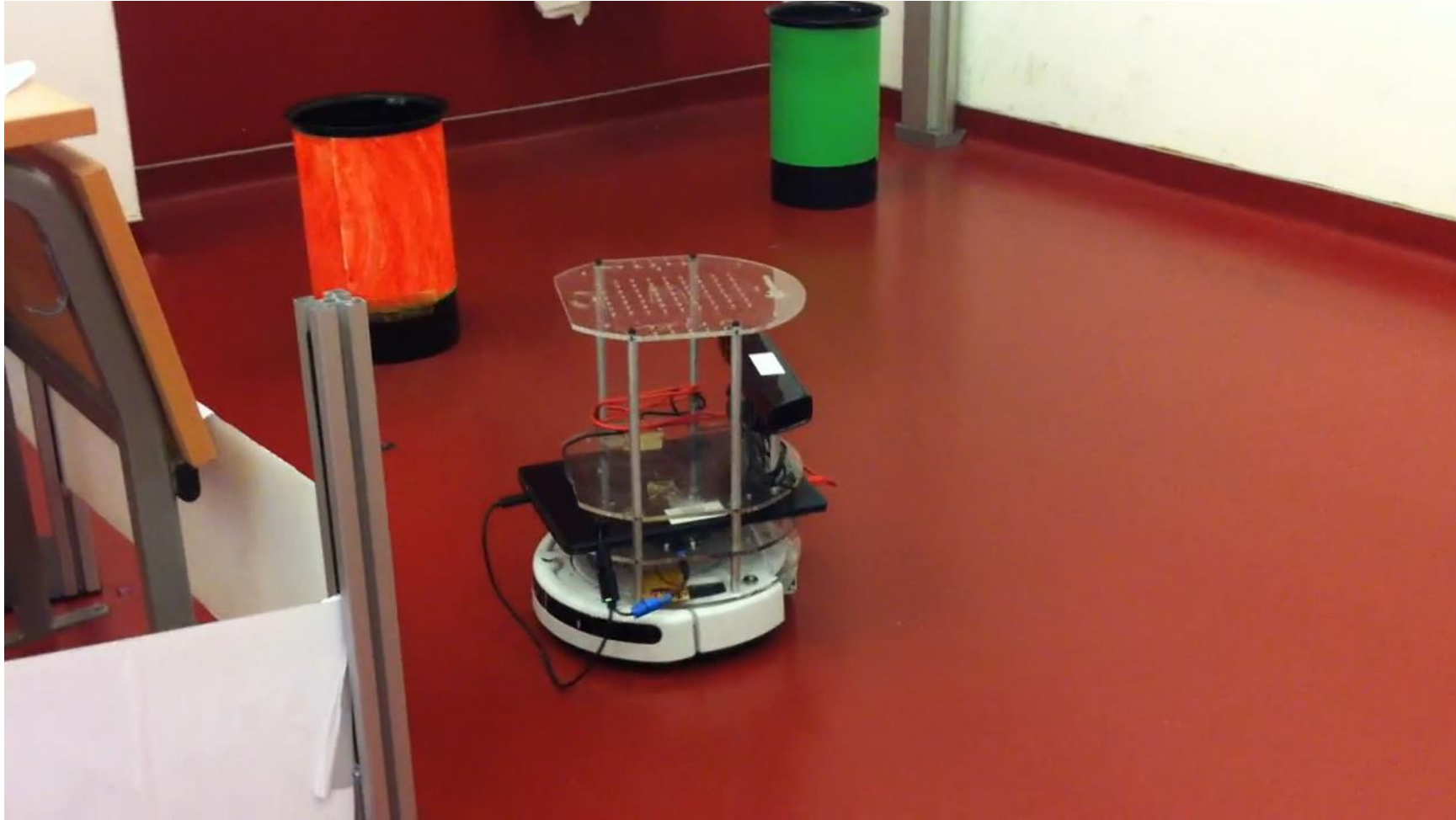

- DeliveryBot



- TaxiBot



- Robot of the rings



- CryptoBot

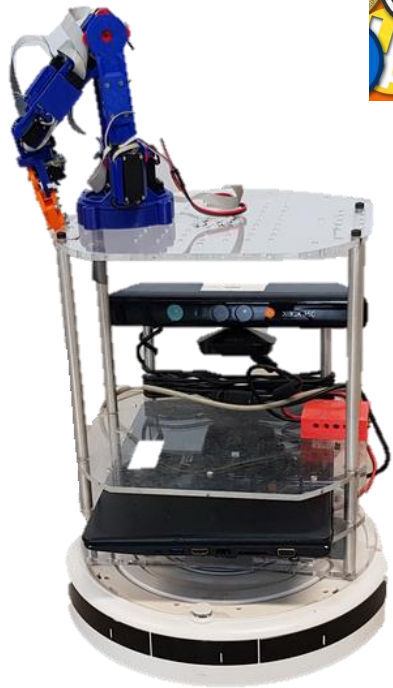

CryptoBot

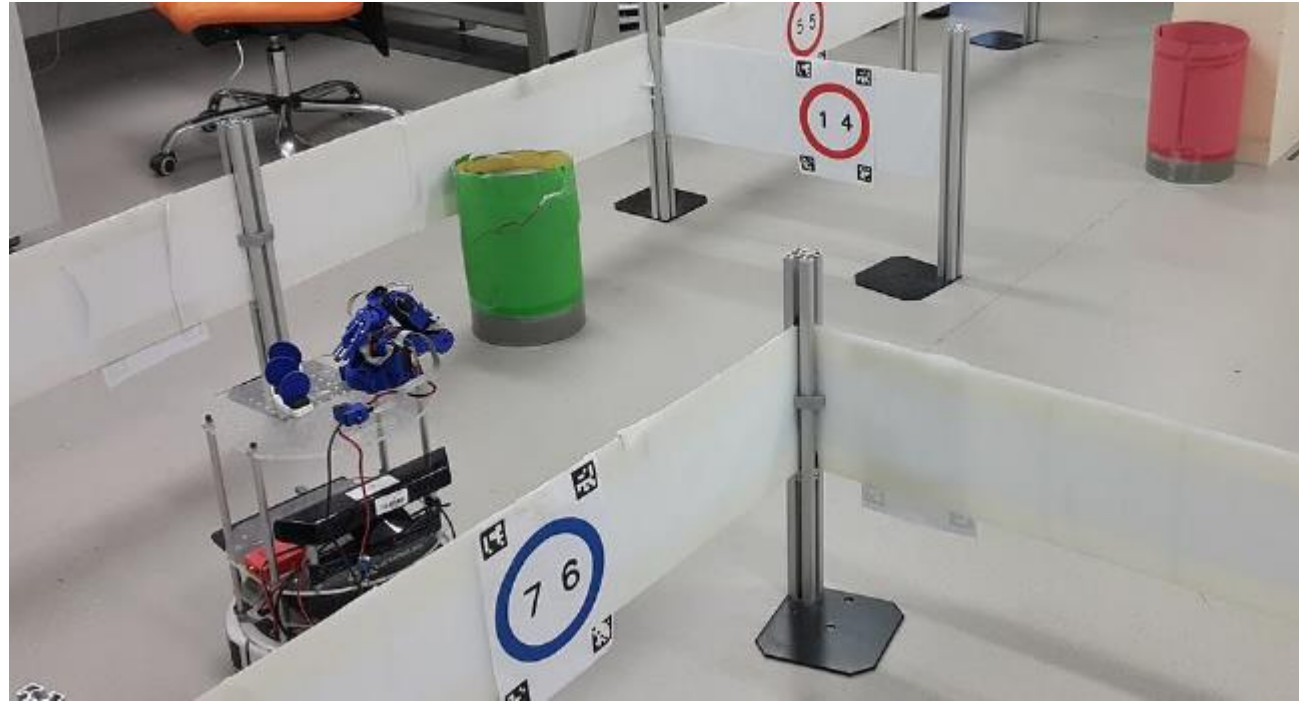

- TreasureHunt

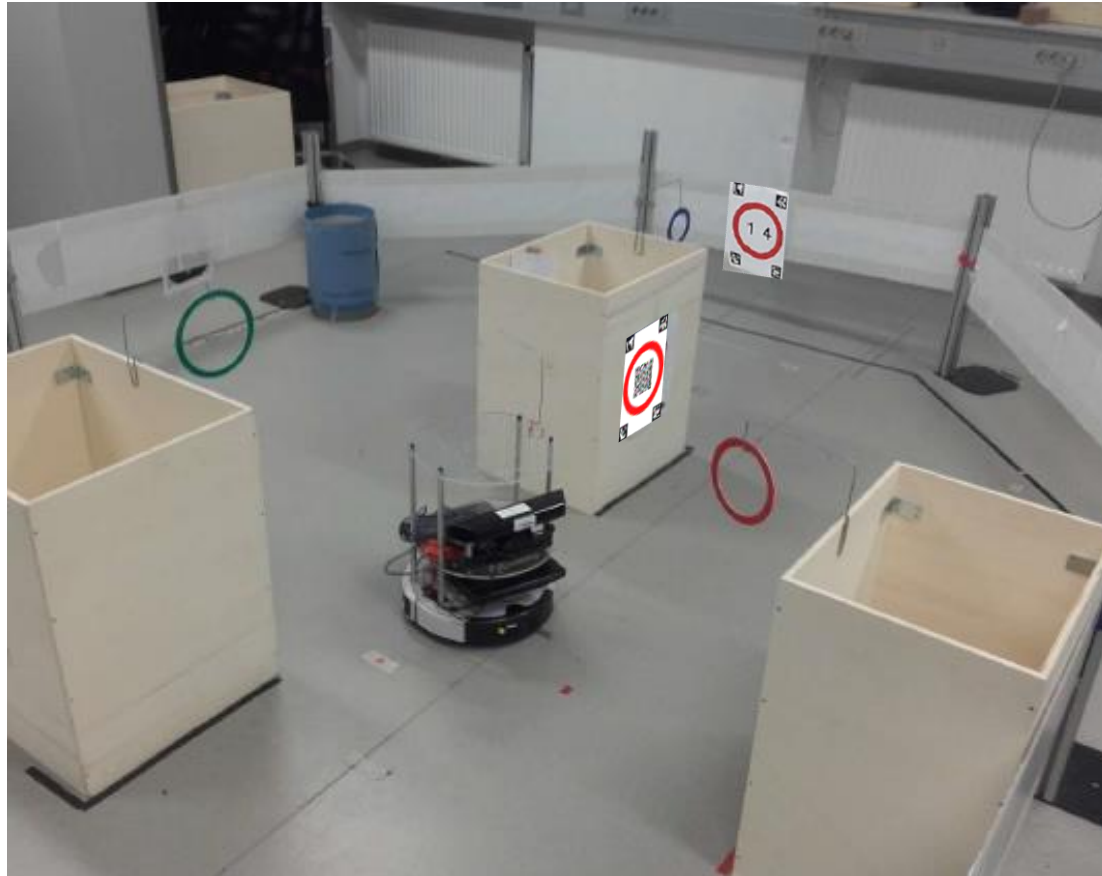

TreasureHunt

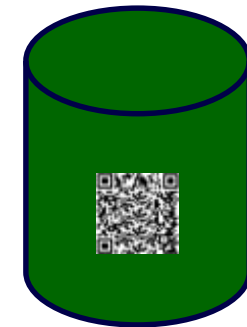
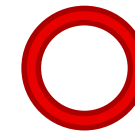
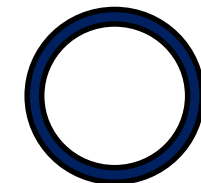
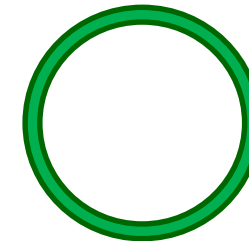
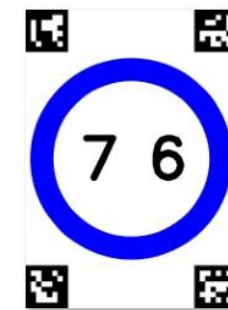
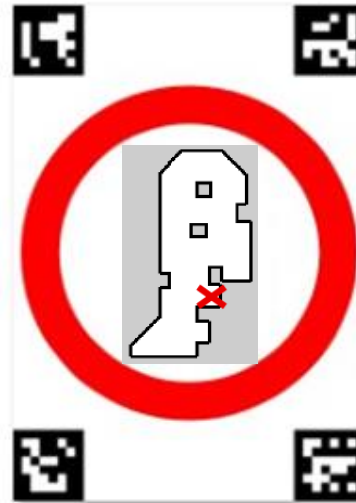

Matchmaker

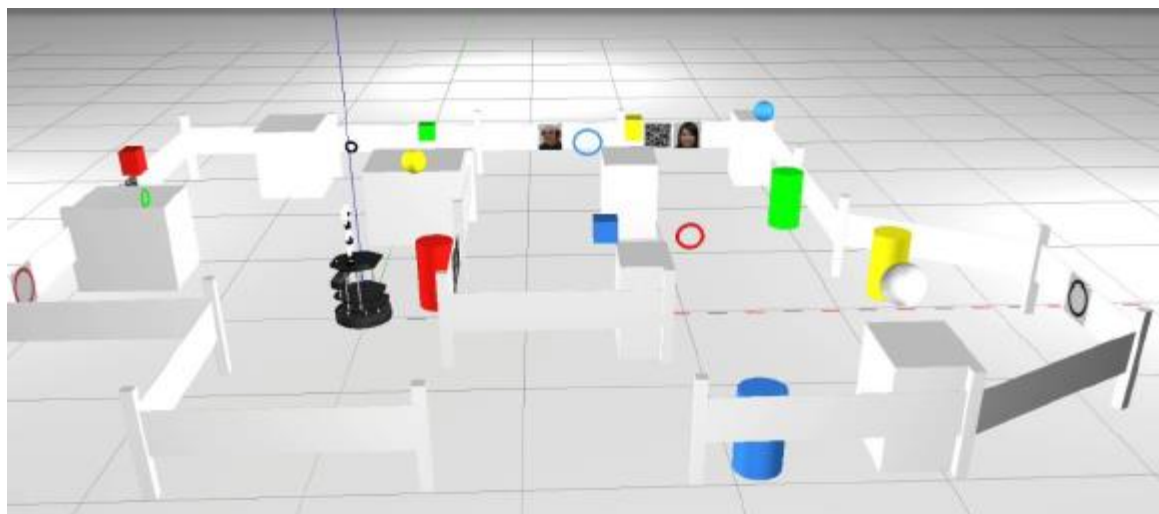

STOPCORONA

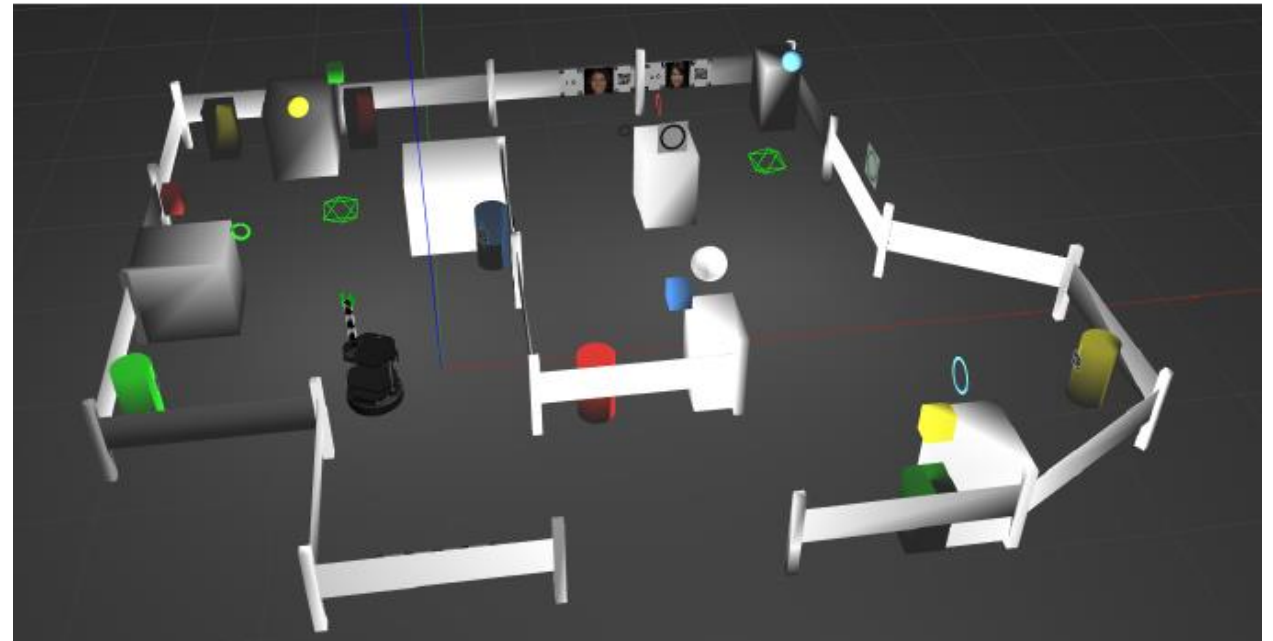
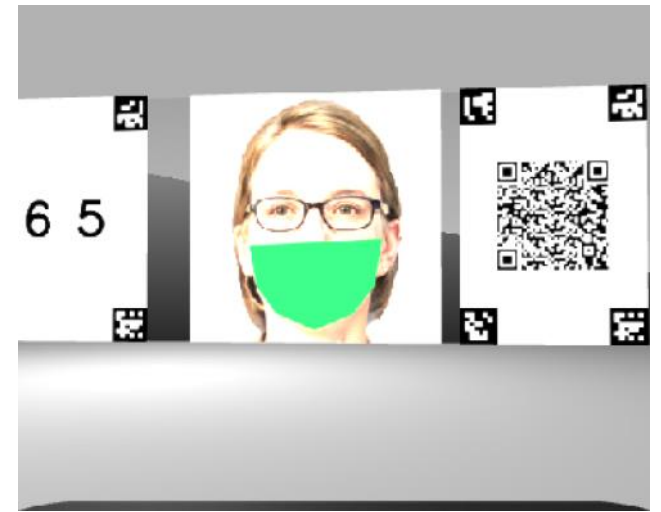

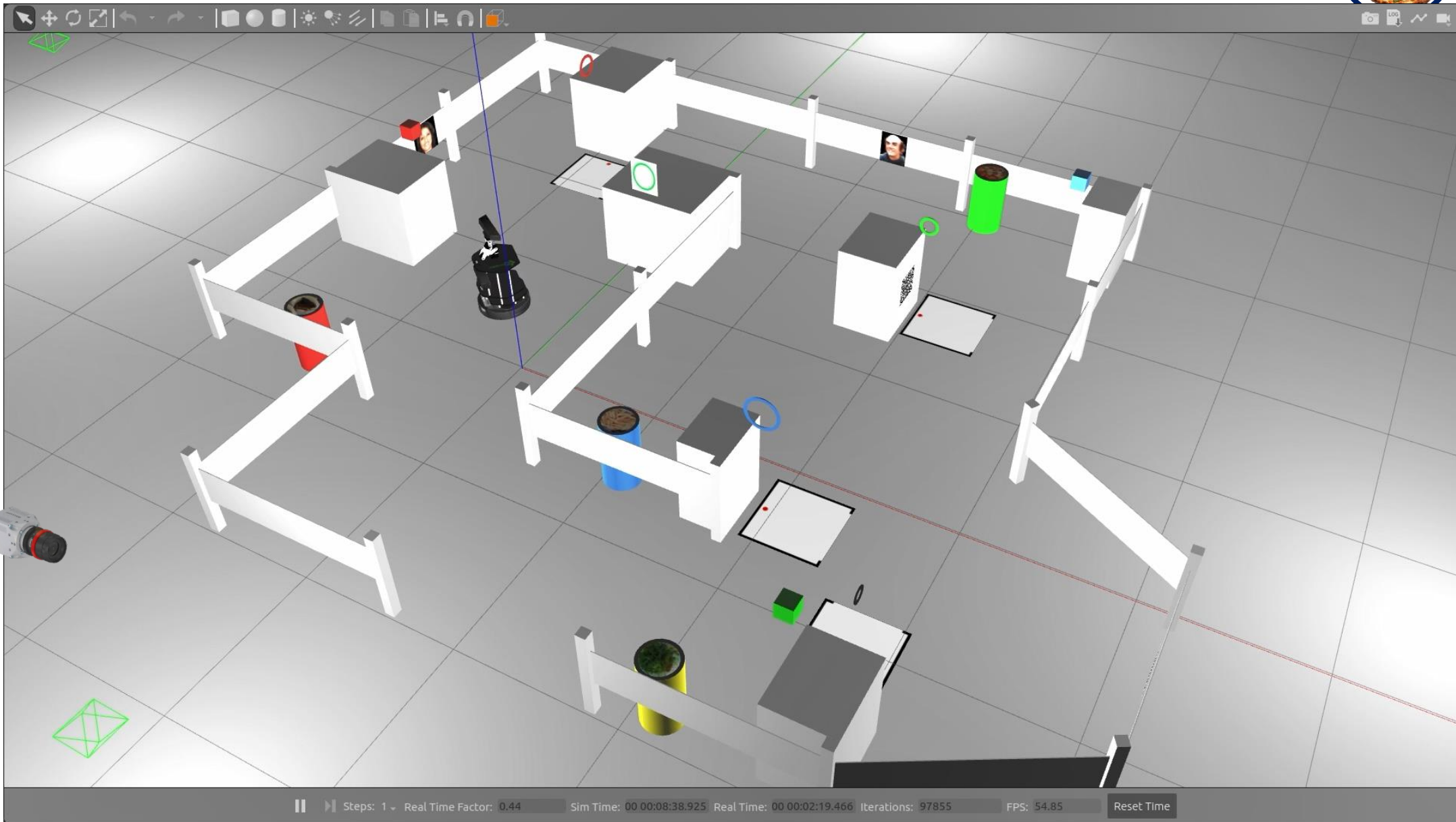
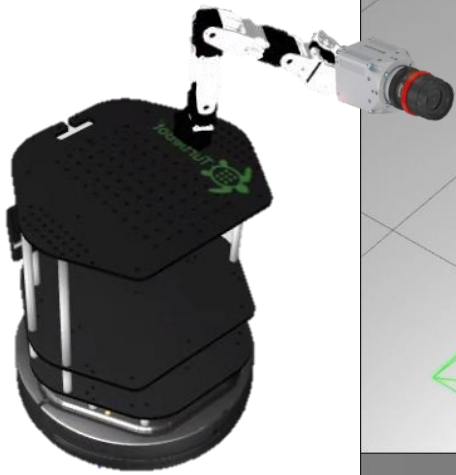



RoboScheriff

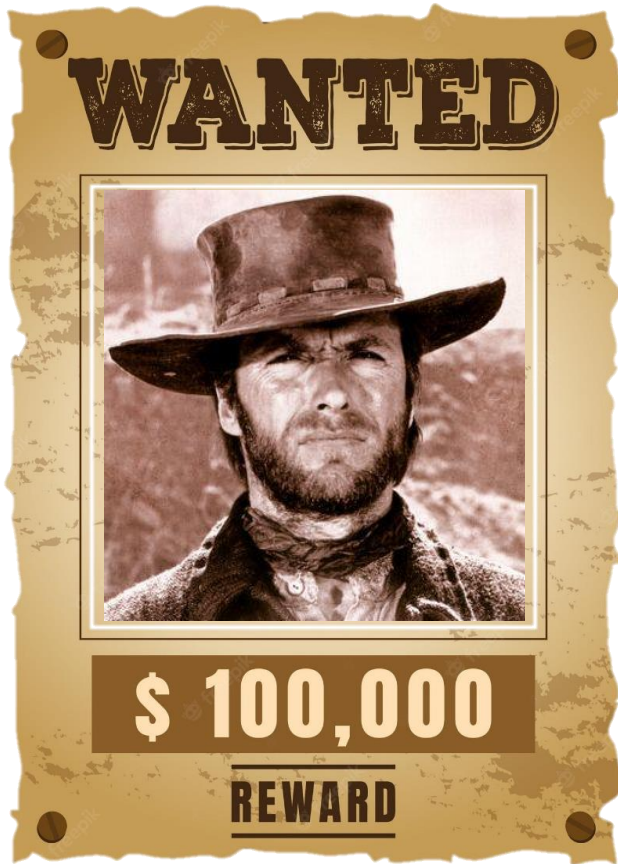

2023 Final task



- Setup:
 - „Small wild west city“ scene (fenced area).
 - Several persons (faces) in the scene.
 - Several „Wanted“ posters in the scene.
 - Four „buildings“ (cylinders) of different colours.
 - Four parking slots marked with rings of different sizes and colours.
- Goal:
 - Imprison the robbers.
- Task:
 - Find all persons in the city.
 - Find the posters and decide which robbers to find and catch.
 - Talk to persons to find out where the robbers are potentially hiding.
 - Look on the top of buildings (cylinders) if the are robbers hidden.
 - When a robber is found, „take“ him to the prison.
 - Find out which building is the prison.
 - Park the robot in front of the prison.



2023 Final task

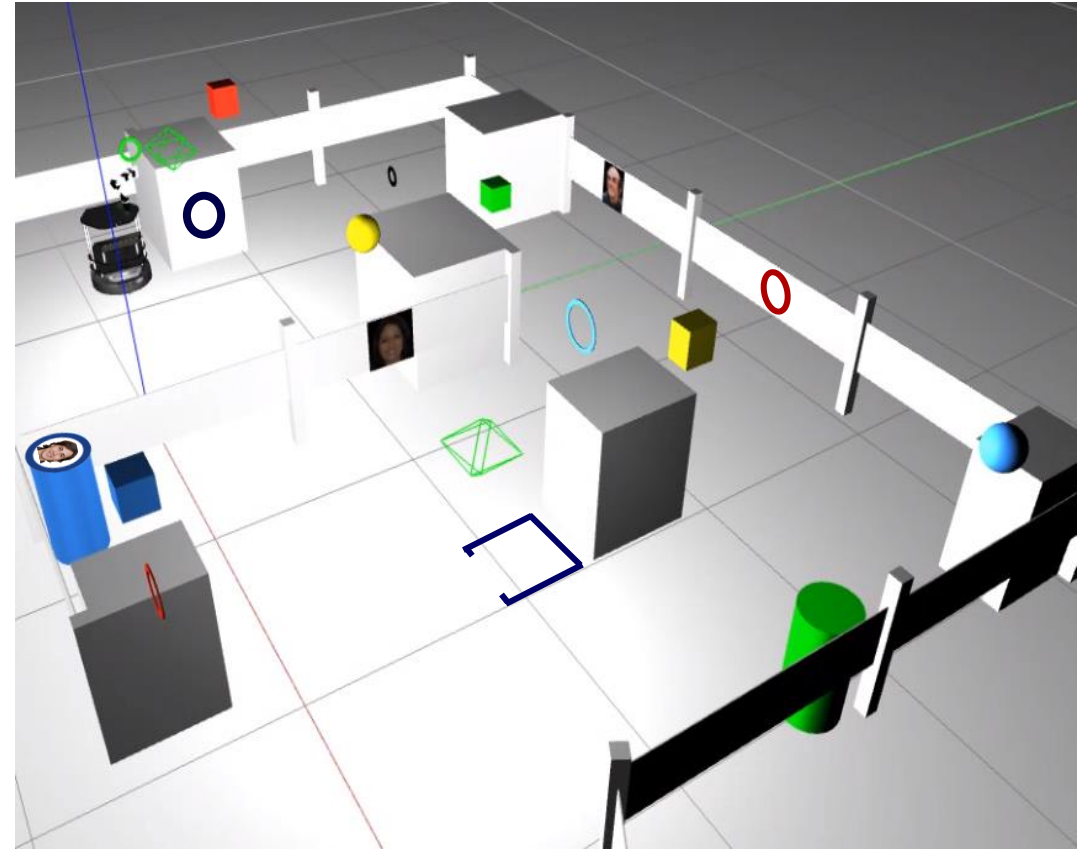
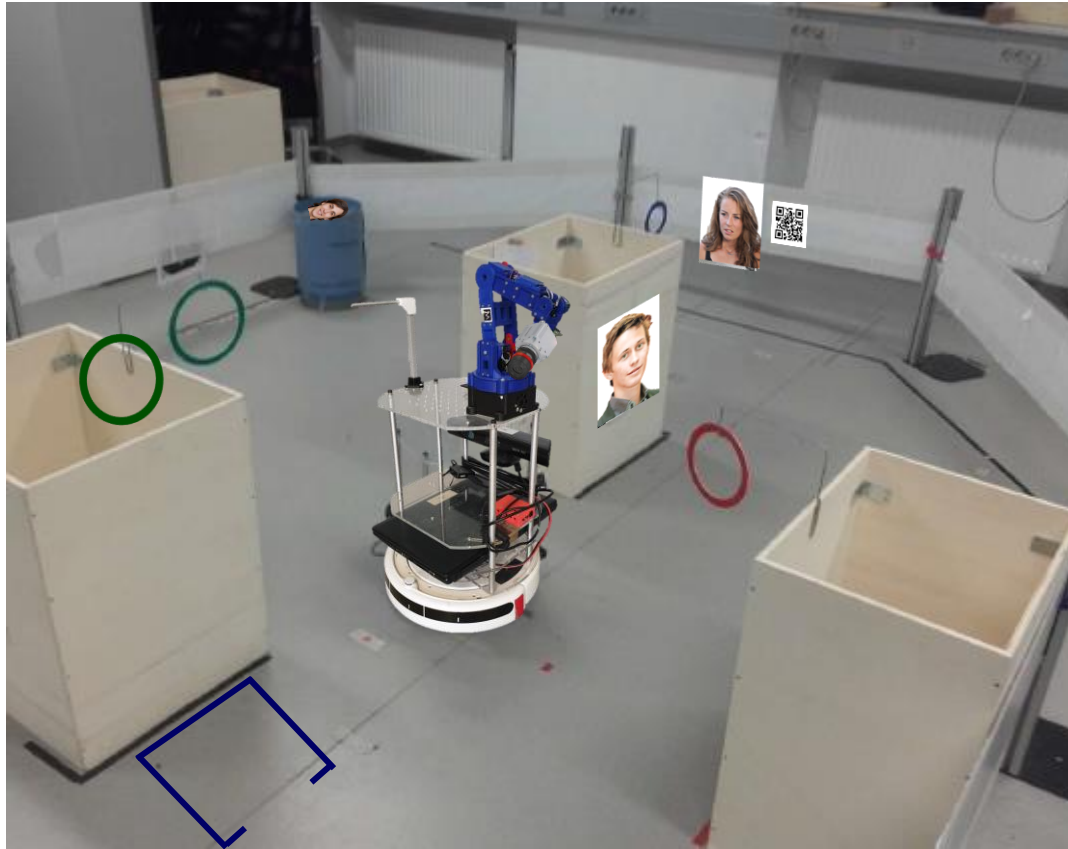

2023 Final task

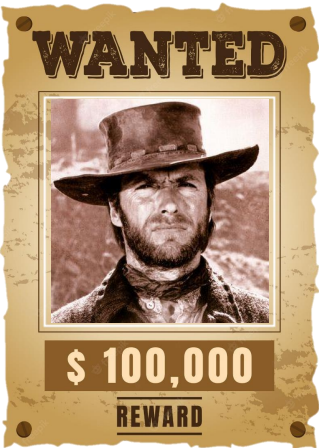
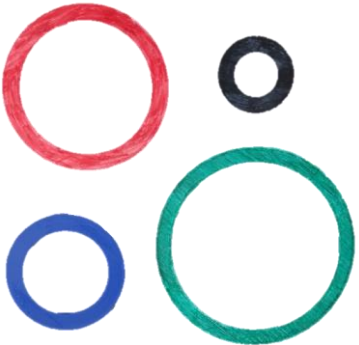
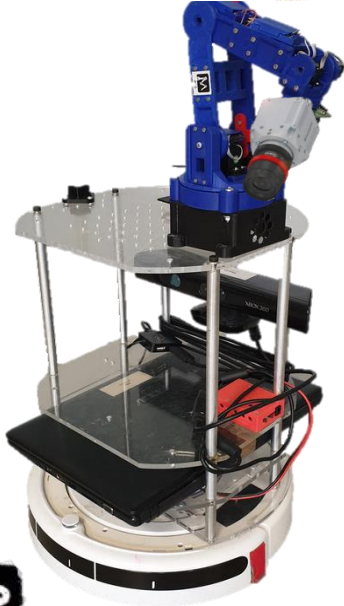

Intermediate tasks

- Task 1: Autonomous navigation and human search
 - The robot should autonomously navigate around the competition area
 - It should search and detect faces
 - It should approach every detected face
 - It should be completed in simulator AND with a real robot in real world
- Task 2: Parking
 - Detect rings
 - Recognize and say the colour of the rings
 - Approach the green ring
 - Detect the marked parking place below the ring
 - Park in the marked parking place

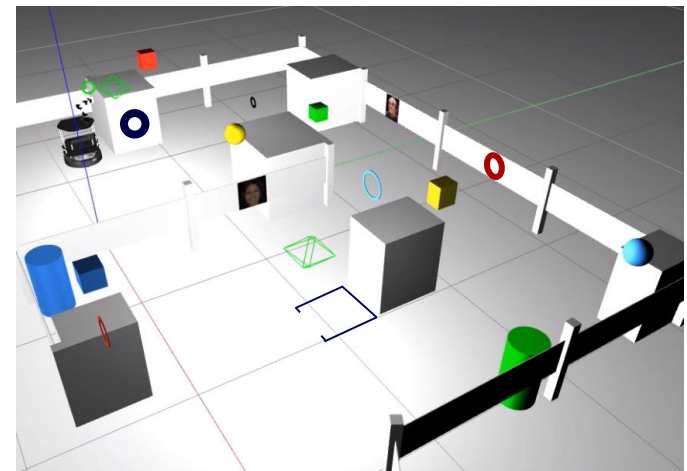

Competencies to be developed

- System setup
 - Running ROS
 - Tele-operating TurtleBot
- Autonomous navigation
 - Autonomous control of the mobile platform
 - Acquiring images and 3D information
 - Simultaneous mapping and localization (SLAM)
 - Path planning, obstacle avoidance
 - Advanced fine manoeuvring
 - Basic mobile manipulation
 - Intelligent navigation and exploration of space
- Advanced perception and cognitive capabilities
 - Detection of faces, circles, 3D rings, 3D cylinders
 - Recognition of faces, digits, colour
 - Speech synthesis, speech recognition, dialogue processing (reading QR codes)
 - Belief maintenance, reasoning, planning

Autonomous navigation

- Autonomous control of the mobile platform
 - components for controlling the robot
- Acquiring images and 3D information
 - using Kinect
 - OpenCV for processing images
 - Point Cloud Library for processing 3D information
- Simultaneous mapping and localization (SLAM)
 - building the map of the environment, navigation using the map
 - transformations between coordinate frames
- Path planning, obstacle avoidance
 - setting the goals, approaching to the specific local goals
 - detect and avoid the obstacles
- Advanced maneuvering
 - precise maneuvering
- Intelligent navigation and exploration of space
 - autonomus exploration, setting the goals

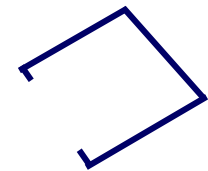
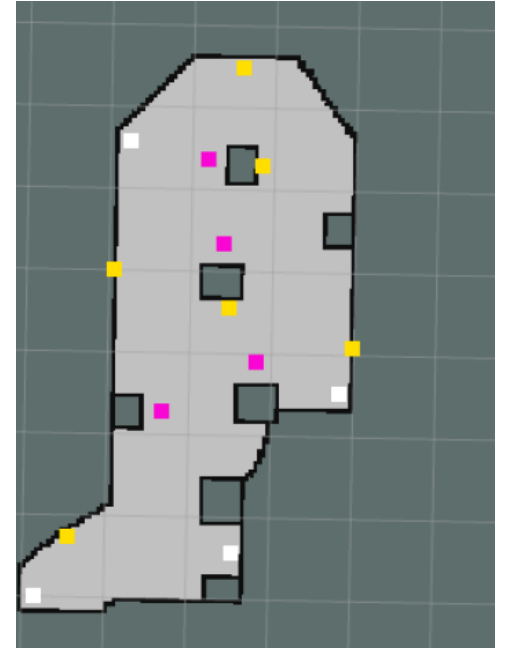

Perception and recognition

- Face detection and recognition
- One-shot learning/enrolment
- Circle detection
- Detection of buildings
 - detection of 3D cylinders
- Detection of rings/shapes
 - localization of rings/shapes in 3D space
- Colour learning and recognition
 - Circles, cylinders, rings
- (QR code reading)

- Dialogue processing
 - Speech synthesis
 - Speech recognition
 - Speech understanding

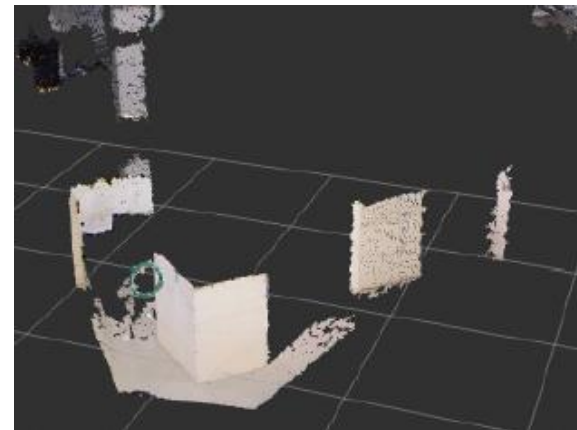

Advanced perception and cognition

- Belief maintenance, reasoning, planning
 - anchoring the detected objects to the map
 - creating and updating the beliefs
 - reasoning using the beliefs
 - planning for information gathering
 - What to do next?
- Intelligent navigation
 - considering the map
 - optimize the exploration of space
 - optimize the distance travelled needed
 - Where to go next?
- Visual servoing
 - move the mobile camera to optimise perception
 - visual servoing while parking

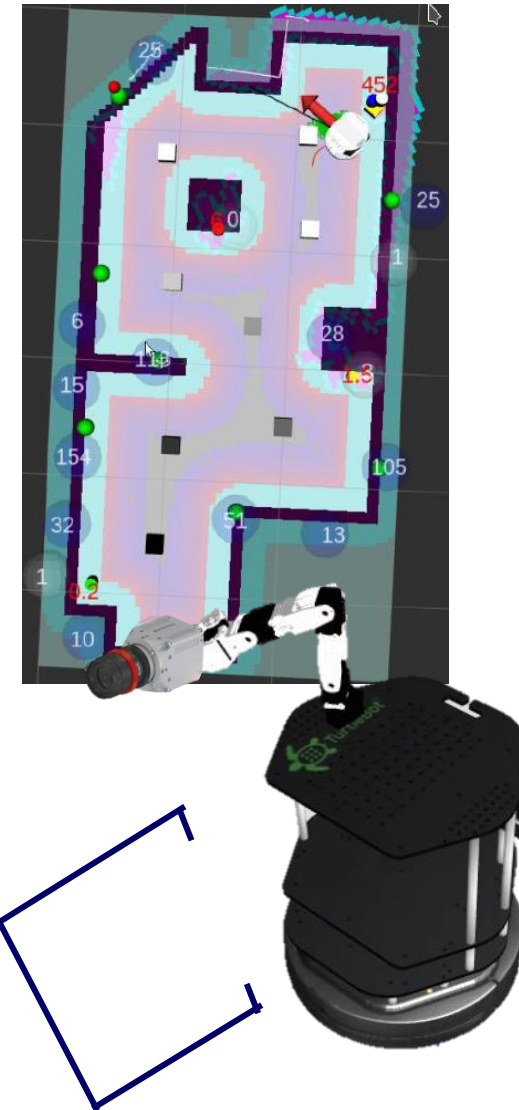

Challenges

- Robot control (ROS)
 - „engineering“ issues
 - robot system (actuators, sensors,...), real world
- Selection of appropriate components for solving subproblems
 - many of them are given, many of them are available in ROS
- Development of new components
 - implementing algorithms for solving new problems
- **Integration**
 - integrating very different components
 - „Estimate the time needed for integration, multiply it by 3, but you have still probably underestimated the time actually needed.“
 - Difficult debugging; visualize, log!
- Very heterogeneous distributed system
 - mobile robotics, navigation, manipulation
 - computer vision, machine learning
 - reasoning, planning

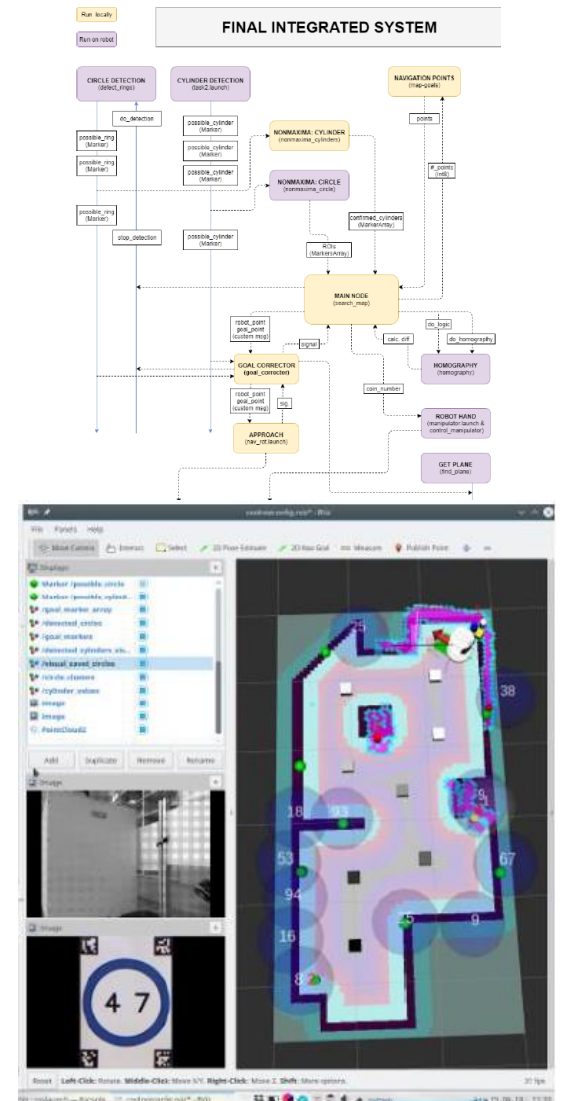

Competencies to be developed

- System setup
 - Running ROS
 - Tele-operating TurtleBot
- Autonomous navigation
 - Autonomous control of the mobile platform
 - Acquiring images and 3D information
 - Simultaneous mapping and localization (SLAM)
 - Path planning, obstacle avoidance, approaching
 - Advanced fine manoeuvring and parking
 - Intelligent navigation and exploration of space
- Advanced perception and cognitive capabilities
 - Detection of faces, circles, 3D rings, 3D cylinders
 - Recognition of faces, digits, colour
 - Basic manipulation and visual servoing
 - Speech synthesis, speech recognition, dialogue processing (reading QR codes)
 - Belief maintenance, reasoning, planning

Types of challenges

- System setup
 - Running ROS
 - Tele-operating TurtleBot
 - Autonomous navigation
 - Autonomous control of the mobile platform
 - Acquiring images and 3D information
 - Simultaneous mapping and localization (SLAM)
 - Path planning, obstacle avoidance, approaching
 - Advanced fine manoeuvring and parking
 - Intelligent navigation and exploration of space
 - Advanced perception and cognitive capabilities
 - Detection of faces, circles, 3D rings, 3D cylinders
 - Recognition of faces, digits, colour
 - Basic manipulation and visual servoing
 - Speech synthesis, speech recognition, dialogue processing (reading QR codes)
 - Belief maintenance, reasoning, planning
- engineering issues
- integration of components
- development of components

Research areas

- System setup
 - Running ROS
 - Tele-operating TurtleBot
 - Autonomous navigation
 - Autonomous control of the mobile platform
 - Acquiring images and 3D information
 - Simultaneous mapping and localization (SLAM)
 - Path planning, obstacle avoidance, approaching
 - Advanced fine manoeuvring and parking
 - Intelligent navigation and exploration of space
 - Advanced perception and cognitive capabilities
 - Detection of faces, circles, 3D rings, 3D cylinders
 - Recognition of faces, digits, colour
 - Basic manipulation and visual servoing
 - Speech synthesis, speech recognition, dialogue processing (reading QR codes)
 - Belief maintenance, reasoning, planning
- Mobile robotics
Computer vision, ML
Dialogue processing, AI

Requirements

- System setup
 - Running ROS For 6
 - Tele-operating TurtleBot For + max. 2
- Autonomous navigation
 - Autonomous control of the mobile platform
 - Acquiring images and 3D information
 - Simultaneous mapping and localization (SLAM)
 - Path planning, obstacle avoidance, approaching
 - Advanced fine manoeuvring and parking
 - Intelligent navigation and exploration of space For + max. 2
- Advanced perception and cognitive capabilities
 - Detection of faces, circles, 3D rings, 3D cylinders
 - Recognition of faces, digits, colour
 - Basic manipulation and visual servoing
 - Speech synthesis, speech recognition, dialogue processing (reading QR codes)
 - Belief maintenance, reasoning, planning

Tasks

- System setup
 - Running ROS Task 1
 - Tele-operating TurtleBot Task 2
- Autonomous navigation Task 3
 - Autonomous control of the mobile platform
 - Acquiring images and 3D information
 - Simultaneous mapping and localization (SLAM)
 - Path planning, obstacle avoidance, approaching
 - Advanced fine manoeuvring and parking
 - Intelligent navigation and exploration of space
- Advanced perception and cognitive capabilities
 - Detection of faces, circles, 3D rings, 3D cylinders
 - Recognition of faces, digits, colour
 - Basic manipulation and visual servoing
 - Speech synthesis, speech recognition, dialogue processing (reading QR codes)
 - Belief maintenance, reasoning, planning

Simulation vs. real-world robot

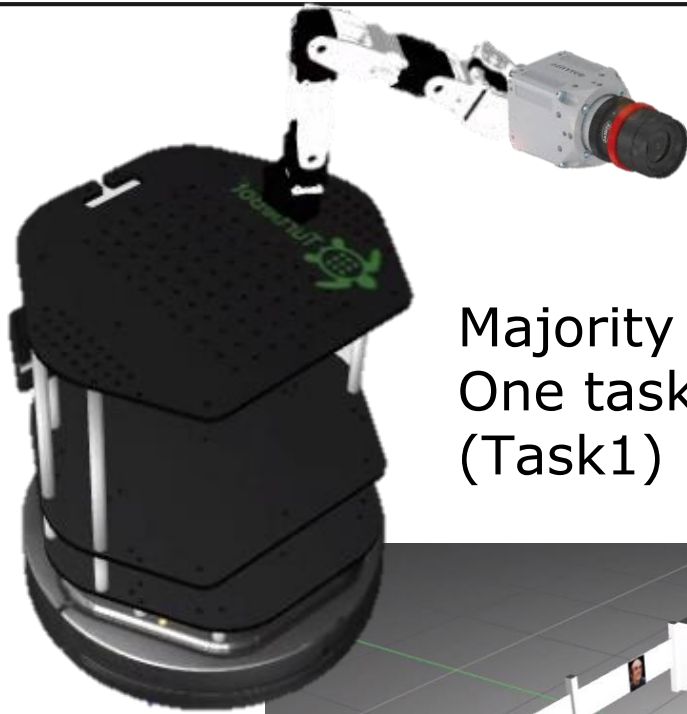

Majority of the tasks to be implemented in simulator
One task has also to be implemented on a real robot
(Task1)

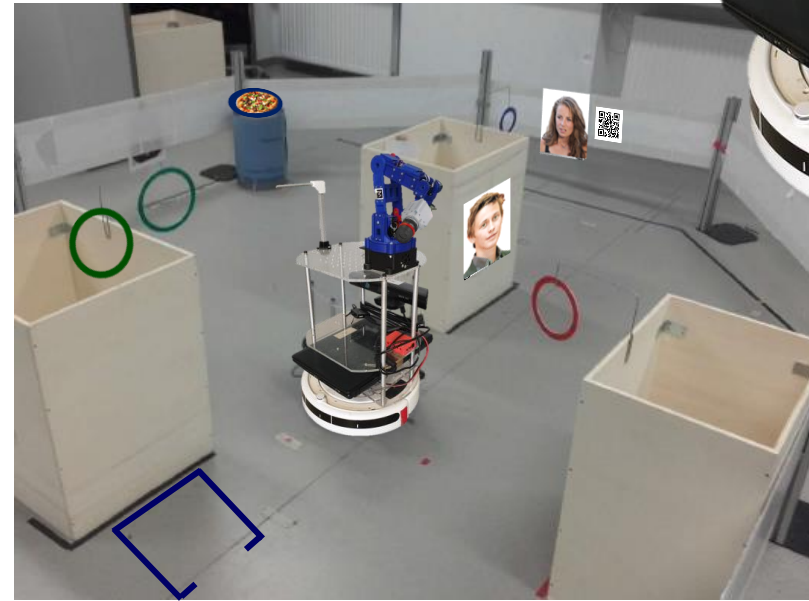
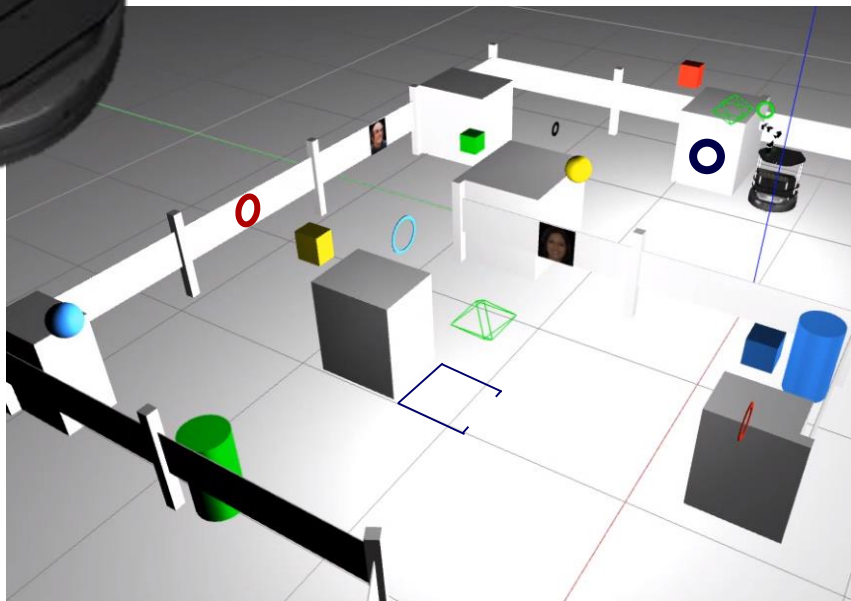

Simulation vs. real-world robot

- System setup
 - Running ROS Sim.+real
 - Tele-operating TurtleBot Sim. only
 - Autonomous navigation
 - Autonomous control of the mobile platform Task 1
 - Acquiring images and 3D information Task 2
 - Simultaneous mapping and localization (SLAM) Task 3
 - Path planning, obstacle avoidance, approaching
 - Advanced fine manoeuvring and parking
 - Intelligent navigation and exploration of space
 - Advanced perception and cognitive capabilities
 - Detection of faces, circles, 3D rings, 3D cylinders
 - Recognition of faces, digits, colour
 - Basic manipulation and visual servoing
 - Speech synthesis, speech recognition, dialogue processing (reading QR codes)
 - Belief maintenance, reasoning, planning
- Optional: also parts of Task 2 and Task 3

- Additional knowledge needed for understanding and implementation of the individual components of the system:
 - introduction to intelligent systems
 - ROS
 - sensors
 - transformations between the coordinate frames
 - mobile robotics
 - computer vision and machine learning
 - robot manipulation
 - artificial cognitive systems

Practical implementation

- Five robots are available
- Teams of three students
- Each team
 - there is at least one good Python/C++ programmer
 - there is at least one member who can work with Linux and robots/hardware
 - there is at least one member good in computer vision and machine learning
 - all the members are equivalent – the work should be fairly distributed – no piggybacking!
 - all the members of the groups attend the same tutorial group
 - preferably also have their own laptop /powerful desktop
 - sufficiently powerful
 - native Linux (Ubuntu 20.04 Focal Fossa,...; ROS Noetic Ninjemys)
 - USB port
- Mobile platforms are available
 - during the practice classes (tutorials)
 - at other times in RoboRoom R2.38 (booking required)

Continuous integration

- It is essential to work during the entire semester
- Time during the official classes does not suffice
- Book the robot and work at other times in RoboRoom R2.38

Robot booking for the course Development of Intelligent Systems											
		Monday					Tuesday				
		29. 4. 2019					30. 4. 2019				
	Timeslot Robot	Thorin	Gloin	Kili	Fili	Oin	Thorin	Gloin	Kili	Fili	Oin
179											
180											
181											
182	00:00 - 01:00										
183	01:00 - 02:00										
184	02:00 - 03:00										
185	03:00 - 04:00										
186	04:00 - 05:00										
187	05:00 - 06:00										
188	06:00 - 07:00										
189	07:00 - 08:00										
190	08:00 - 09:00										
191	09:00 - 10:00										
192	10:00 - 11:00	nu	pi	beta	omicron	gamma	zeta	pi	beta	ksi	gamma
193	11:00 - 12:00	nu	pi	beta	omicron	gamma	zeta	eta	beta	ksi	gamma
194	12:00 - 13:00	nu	pi	beta	omicron	gamma	zeta	eta	beta	ksi	gamma
195	13:00 - 14:00	nu	pi	beta	omicron	gamma	zeta	eta	beta	ksi	gamma
196	14:00 - 15:00	eta	pi		omicron	alpha	zeta	epsilon	theta	ksi	gamma
197	15:00 - 16:00	eta		kappa		alpha		epsilon	theta	nu	
198	16:00 - 17:00	eta		kappa		alpha		epsilon	theta	nu	
199	17:00 - 18:00			kappa		alpha		epsilon	theta	nu	
200	18:00 - 19:00			kappa		alpha		epsilon	theta	nu	
201	19:00 - 20:00			kappa						nu	
202	20:00 - 21:00										
203	21:00 - 22:00										
204	22:00 - 23:00										
205	23:00 - 24:00										
206											
207											
208											
209											
210	00:00 - 01:00	zeta	beta	lambda	gamma	eta					
211	01:00 - 02:00	zeta	beta	epsilon	gamma	eta					
212	02:00 - 03:00	zeta	beta	theta	epsilon	eta					
213	03:00 - 04:00	zeta	beta	theta	epsilon	eta					
214	04:00 - 05:00	zeta	beta	lambda	epsilon	eta					
215	05:00 - 06:00	kappa	lambda		ksi						
216	06:00 - 07:00	kappa		ksi							
217	07:00 - 08:00	alpha	mu	ksi		kappa					
218	08:00 - 09:00	alpha	mu	omicron	delta	kappa					
219	09:00 - 10:00	alpha	pi	omicron	delta	kappa					

Milestones

- Milestone 1: Autonomous navigation and human search
 - Autonomous navigation around the competition area
 - Find and approach the faces
 - Milestone 2: Parking
 - Detect the 3D rings
 - Basic visual servoing
 - Fine manoeuvring and parking
 - Milestone 3: RoboSheriff
 - Imprison the robbers
 - Computer vision, machine learning
 - Dialogue, mobile manipulation
 - Belief maintenance, reasoning, planning
- + Autonomous navigation and human search on a real robot

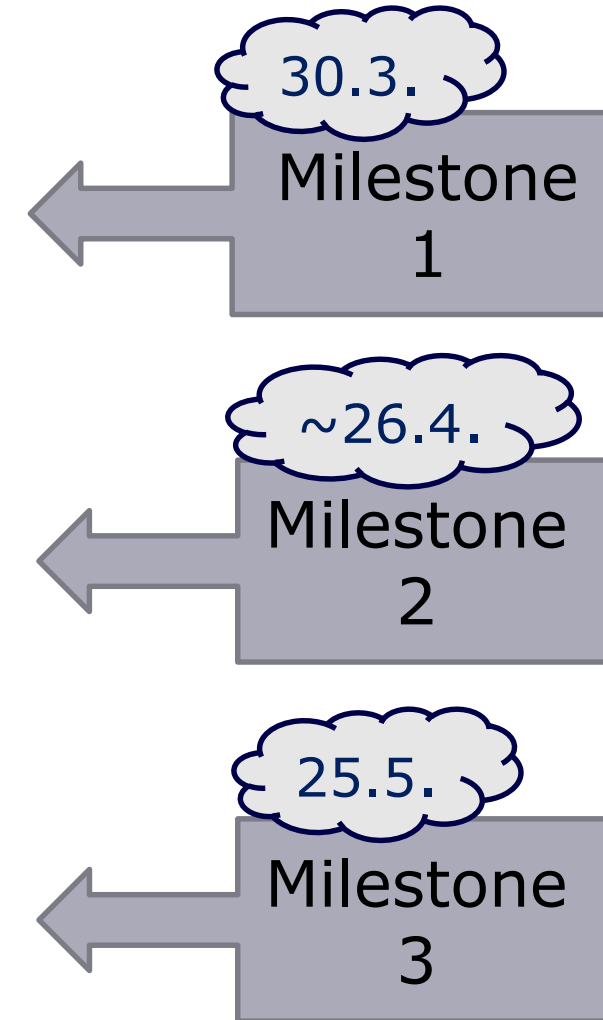

Evaluation

- Huge emphasis on practical work
- Continuing work and assessment during the semester
- Different levels of requirements available
- There is no written exam!
- Oral exam
- Grading:
 - 10 points: M1 in simulator (system operation)
 - 10 points: M1 on real robot (system operation)
 - 15 points: M2 in simulator (system operation)
 - 25 points: M3 in simulator (concepts used, system operation, system performance)
 - 10 points: Final report (description of the methods used, experimental results, implementation, innovation)
 - 10 points: Active participation (participation at the practice classes, active work in the lab, active problem solving, homeworks)
 - 20 points: Oral exam (concepts presented during the lectures, discussion about theoretical and implementation details of the developed system, experimental results)

Requirements

- Requirements:
 - at least 30 points (50%) earned at milestones
 - at least 5 points (50%) for the final report
 - at least 50 points (50%) altogether
- If the student fails to carry out the work in time (fails to successfully demonstrate the robot at the milestones), he/she can not pass the course in the current academic year.
- If the student does not pass the oral exam, he/she is allowed to take it again (this year).
- If it is determined that the student has not contributed enough to the development of the system in his/her team, he can not pass the course in the current academic year.
- The students have to participate in the continuous assessment of their work (at milestones M1, M2, M3).
- Attendance at the practice classes is compulsory.
- Completed requirements are only valid in the current academic year.

Conclusion

- Very „hands-on“ course
- Gaining practical experience on a real robot
- Real-world problems
- Collaboration
- Creative thinking
- Problem solving
- Innovativeness
- Practical skills

